

Pos. Nr. Pos.no.	Beschreibung Description	Art.-Nr. Art.no.	Preisgruppe Price bracket
710005	CSD Br 375	=	
711005		=	🔊
1	Kessel kpl. Betr.nr. 375 002 Boiler ass. loco no. 375 002	150950	25
2	Führerhaus kpl. Drivers cab ass.	150951	18
3	Lokflexplatine Loco flex printed circuit	109241	13
4	Kesselgewicht Boiler weight	133812	8
5	Steckteilesatz Part set	109249	13
6	TS - Griffstangen + Halter Part set handrail + holder	109267	8
7	Puffer flach Buffer flat	109268	5
8	Puffer gewölbt Buffer vaulted	109269	5
9	Steckverbindung Plug and socket	109272	15
10	Steckteil für Umlauf Push in part for running board	109276	3
11	Pfeife Whistle	109277	9
12	Drahtlampe T3/8 3 Volt 20 mA Light bulb	109278	8
13	TS - Fenster + Lichtleiter Part set window + light conductor	109279	13
14	Reversierstange 64,5mm Reversier rod	109289	3
15	Steckteilesatz Part set-Plug-in parts	125569	8
16	TS - Kesselsteckteile Part set boiler	109298	12
17	Steckteilesatz Part set-Plug-in parts	110233	12
18	Laterne unten komplett Lantern down ass.	110236	8
19	TS - Kessel Par set boiler	133379	6
20	GF-Schraube M1,6x6 mm GF-Screw	114836	3
21	GF-Schraube M2x5 mm GF-Screw	114966	3
22	TS-Leitungen Part set-Lines	115162	6
23	Kesselplatine komplett Boiler printed circuit ass.	115166	23
24	Pfeife Whistle	110245	9
25	Domring Dome ring	140389	5
26	Umlaufblech ES Running board	110253	12
27	TS - Kessel + Umlauf Part set boiler + running board	109239	12
28	Lokplatine komplett Loco printed circuit ass.	149415	17
29	Luftpumpe Air pump	122731	4
30	Rauchkammertür montiert Smoke door ass.	110285	7
31	TS - Behälter + Stützblech Part set box...	109232	12
32	TS-Kessel Part set boiler	109233	9
33	Kesselleitung + Steuerstangen Boiler line + steering rod	109296	16
34	Pufferbohle Headstock	109270	4
35	TS - Leitung + Kessel Part set line + boiler	124710	6
36	Türverschluss Door lock	110286	4
37	Brückenstecker Jumper	100644	6
38	Bühne hi. Rear platform	150946	11

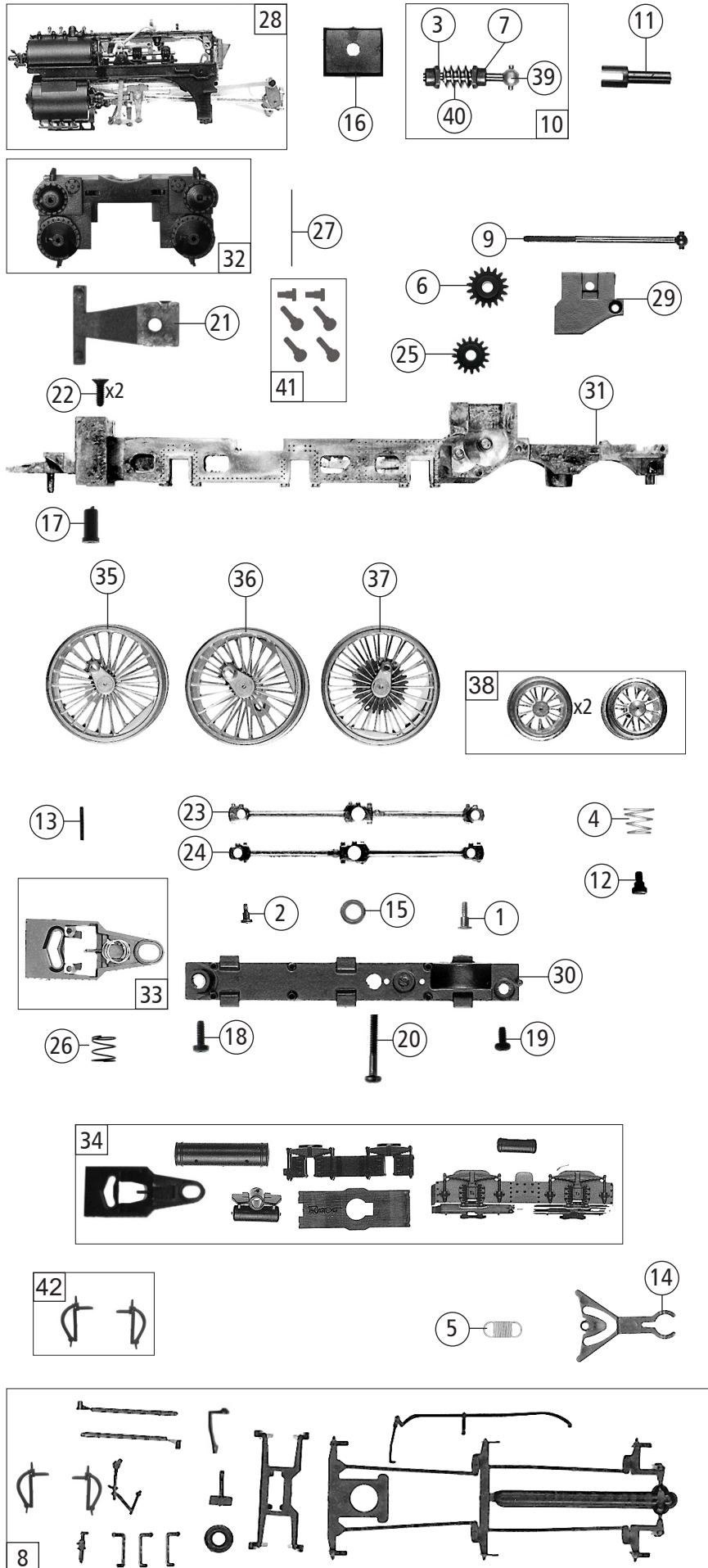

Pos. Nr. Pos.no.	Beschreibung Description	Art.-Nr. Art.no.	Preisgruppe Price bracket
1	Ansatzschraube 6-Kant M1.4/6.1 Screw	85720	5
2	Schraube M1,4x3,2/1.1 Screw	85764	3
3	Beilagscheibe 2.1 x 4 / 0.2 mm Washer	86108	3
4	Feder Spring	86202	3
5	Zugfeder Spring	86208	3
6	Schnecken Zahnrad Z=15/14 Worm gear	86490	5
7	Lager für Schneckenachse Bearing for worm axle	89749	6
8	Steckteilesatz Push in part set	109234	12
9	Kardanwelle Cardan shaft	109238	5
10	Schneckensatz kpl. Worm set ass.	109242	13
11	Kardanschale lang Cardan bearing long	109248	5
12	Ansatzschraube Screw	109252	3
13	Kontaktstift 1x8,5 mm Contact pivot	109545	4
14	Lok-Tender-Kupplung Loco-tender coupling	109546	5
15	Treibstangenring Connecting ring	110232	3
16	Schneckendeckel Worm cover	111987	4
17	Isolierbuchse Insulating bush	112109	3
18	GF-Schraube M2X6 mm GF-Screw	114828	3
19	GF-Schraube M2x4 mm GF-Screw	114877	3
20	GF-Schraube M2X18 mm GF-Screw	115062	3
21	Stütze Bracket	115155	3
22	SK-Schraube M1,6X4 m SK-Screw	115161	3
23	Kuppelstange rechts Connecting rod right	110229	7
24	Kuppelstange links Connecting rod left	110230	7
25	Zahnrad Z=16 - schwarz Gear black	117617	3
26	Laufgestell druckfeder Spring	115176	3
27	Drahtstift Wire-pin	110641	4
28	Steuerung kpl. Steering ass.	150948	30
29	Lok-Getriebedeckel lackiert Loco gear cover coated	110235	12
30	Lokboden Loco bottom	109246	10
31	Lok-Grundrahmen lackiert Loco base frame coated	109247	16
32	Zylinderblock kpl. Cylinder block ass. compl.	150949	13
33	TS - Vorlaufgestell Part set pilot frame	110248	12
34	TS - Nachlaufgestell Part set tail frame	109232	12
35	Treibradsatz 1 mit Achslager Wheelset 1	110237	17
36	Kuppelradsatz 2 mit Achslager Wheelset 2	110238	17
37	Kuppelradsatz 3 mit Zahnrad Wheelset 3	110239	17
38	TS - Radsätze Lok hoher Spurk. Part set-Loco wheelsets high gauge.	110257	16
39	Kardankugel Cardan ball	109614	4
40	Schnecke Wormgear	86720	6
41	Steuerungsnieten kurz+lang Reversing gear rivets short+long	113252	8
42	Bremsschlauch li.+re. Brake hose L+R	115635	4

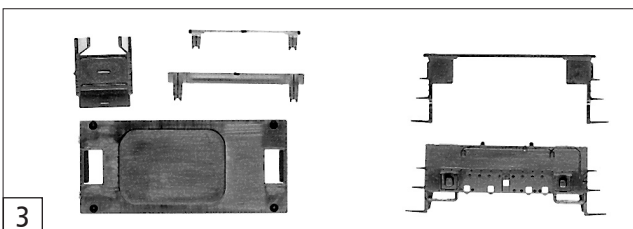
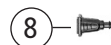
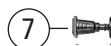
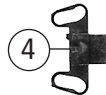
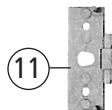
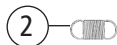
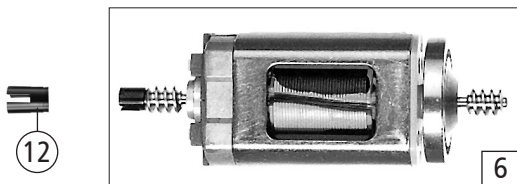
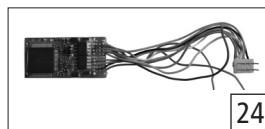
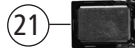
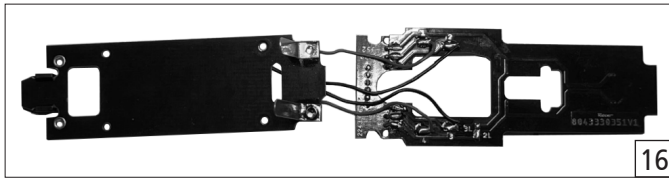
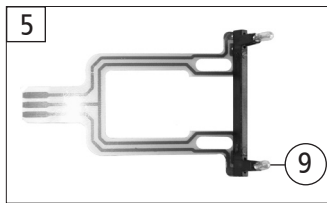
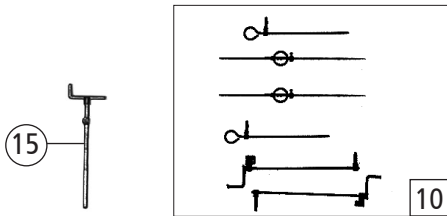
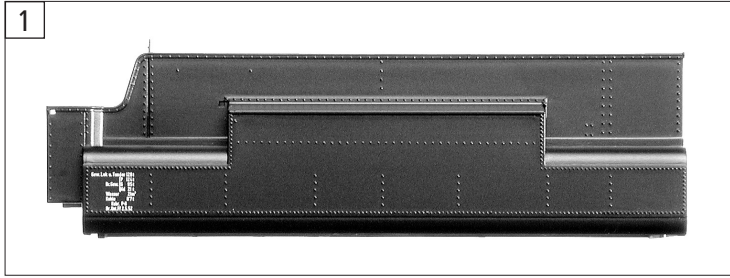
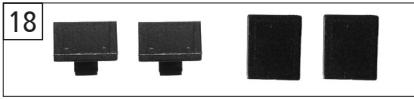
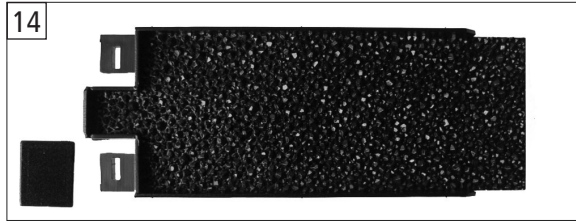

Pos. Nr. Pos.no.	Beschreibung Description	Art.-Nr. Art.no.	Preisgruppe Price bracket
710005 CSD Br 375 =			
711005 = 🔊			
1	Tendergehäuse lack. Tender body coated	150947	20
2	Zugfeder RD 2.5X4.3X0.15 Spring	86249	3
3	Tender Teilesatz Part set tender	109256	9
4	Tenderkupplung Tender coupling	109258	5
5	Flexplatine Tender Flex printed circuit for tender	109260	14
6	Motor Motor	109261	28
7	Puffer flach Buffer flat	109268	5
8	Puffer gewölbt Buffer vaulted	109269	5
9	Drahtlampe T3/8 3 Volt 20 mA Light bulb	109278	8
10	Steckteilesatz Part set	109295	15
11	Kupplungsplatte Coupling plate	109547	4
12	Kardanhülse Cardan bush	109548	5
13	Laterne unten komplett Lantern down ass.	110236	8
14	Kohle, Deckel Coal, cover	110262	8
15	Bremskurbel Brake crank	115163	3
16	Tenderplatine kpl. Tender printed circuit ass. compl.	149414	18
17	Motorspange Motor clamp	108264	3
18	Werkzeugkasten u. Deckel Tool box and cover	133373	10
19	Kohlebürste Carbon brush	89743	6
20	Bürstenfeder Carbon brush spring	114197	3
Sound			
21	Lautsprecher Loudspeaker	129524	13
22	Lautsprecherplatine PCB for loudspeaker	128481	10
23	GF-Schraube M1,6x4 mm Self-tapping screw	114850	3
24	Sounddecoder Sound-decoder	149800	39

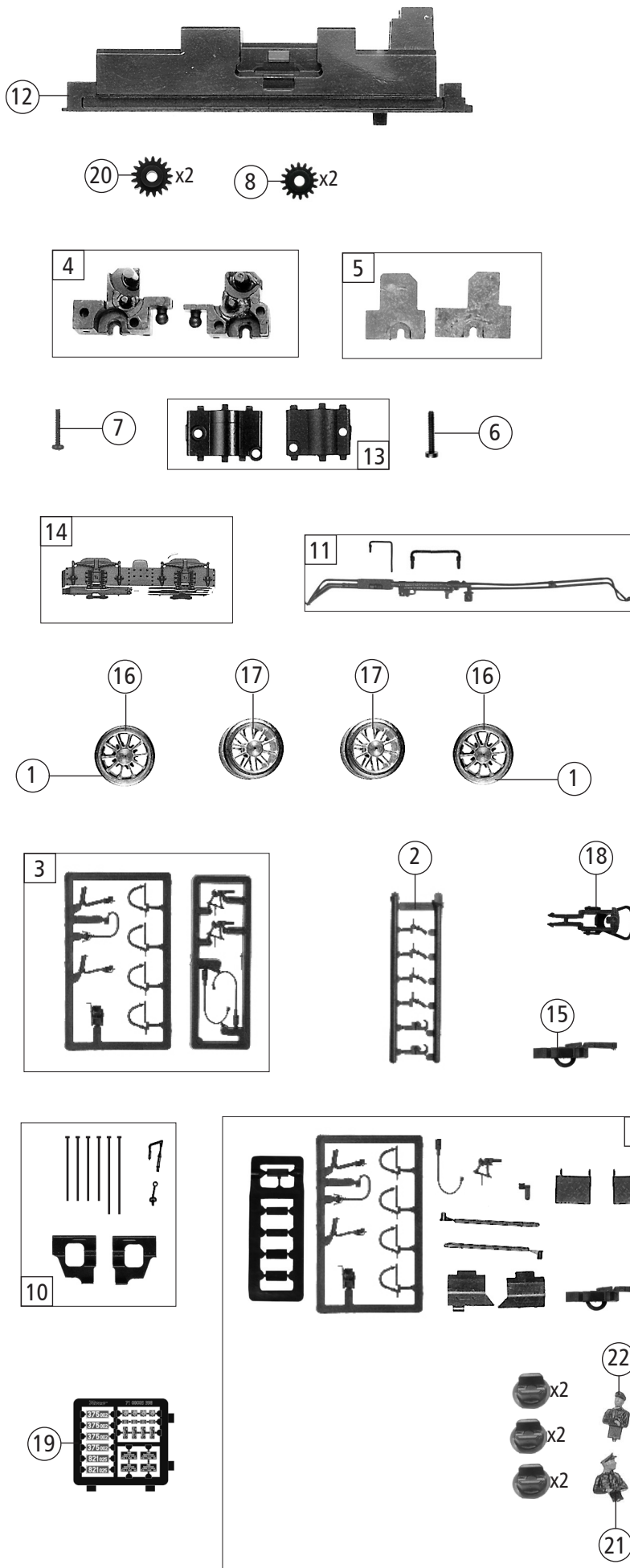

Pos. Nr. Pos.no.	Beschreibung Description	Art.-Nr. Art.no.	Preisgruppe Price bracket
710005	CSD Br 375	=	
711005		=	🔊
1	Hafringsatz - 10 Stück Set with traction tires 10pieces	40074	---
2	Attrappenrahmen Push in part set	107808	4
3	Zubehörrahmensatz Push in part set	108322	7
4	Tendergetriebebesatz 2-teilig Tender gear set 2-parts	109245	8
5	Getriebedeckel vorne + hinten Gear cover fore and aft	109265	8
6	GF-Schraube M1,6X10 mm GF-Screw	114881	3
7	GF-Schraube M1,6x8 mm GF-Screw	115037	3
8	Zahnrad Z=16 - schwarz Gear black	117617	3
9	Zurüstbeutel Bag with accessories	150952	12
10	Zurüstbeutel Zurüstteile Bag with accessories	109282	8
11	Leitungen Lok u. Tender Lines for loco a. tender	109235	9
12	Tenderunterteil lackiert Tender base frame coated	109292	16
13	Getriebeboden vorne + hinten Gear bottom fore and aft	109266	8
14	Tenderblende m. Kontakten Tender bogie w. contact	109294	12
15	Kurzkupplung Vo-rentkupplung Short coupling pre-uncoupling	115550	6
16	Radsatz m. Hafringen+Zahnrad Wheelset w. traction tires w. gear	110272	14
17	Radsatz o. Zahnrad Wheelset w/o gear	110270	14
18	Standardkupplung Standard coupler	89246	6
19	Tafelsatz Set of panels	150953	12
20	Schnecken Zahnrad Z=15/14 Worm gear	86490	5
21	Lokführer seitlich Loco driver at the side	89724	6
22	Heizer/E-Lokführer Fireman/E-loco driver	89725	6